

# Hour meter

## HK 30



### Highlights

- price competitive meter
- excellent quality
- long lifetime
- different models for different markets
- all necessary approvals
- your branding available

### Applications

- gen-sets
- compressors
- pumps
- medical equipment
- control panels
- air conditioning

### Mechanical data

Front dimension: 36 x 24 mm (standard)

Display	AC: 5 integers, 2 decimals DC: 6 integers, 1 decimal without reset
Digit height	4 mm
Digit color	integer: white on black decimal: 50 Hz – red on black 60 Hz – black on white
Counting range	AC: 99999,99 h, DC: 999999,9 h
Reading accuracy	AC: 1/100 h (36 sec) DC: 1/10 h (6 min)
Weight	ca. 32 g
Housing color	standard black transparent on request
Bezels for 36x24 mm	48x24, 48x48, 54x29, 55x55, Ø 58, Ø 72, 72x72 mm
Mounting options	D – DIN housing E – 48x48 DIN case G – front 36x24mm with retainer R – front 40,6x27,5mm (1,60x1,08") with retainer S – 2-screw front 52x26mm (2,05x1,03")

### Electrical data

Operating voltage 24, 48, 60, 110, 120, 220, 230, 240, 400 VAC ± 10%, 50 or 60 Hz

6-12, 12-36, 36-80, 110, 220 VDC ± 10%

Current consumption AC: max. 8 mA  
DC: max. 9 mA

Accuracy AC: ± 0,02 %  
DC: ± 0,002 %

Connection flat pin 6,3x0,8 with screw  
flat pin 6,3x0,8

### Ambient conditions

Operating temperature AC: -25° C .. +70° C  
DC: -10° C .. +55° C

Storage temperature AC: -40° C .. +70° C  
DC: -20° C .. +70° C

Relative humidity max. 80% at +25° C

Protection IP40 front  
IP67 front (transparent housing)  
IP67 totally sealed housing  
IP00 terminals

Approvals CE Mark  
UL E171200

RoHS compliant

### Ordering

### HK 30 . x x / x x x / x x

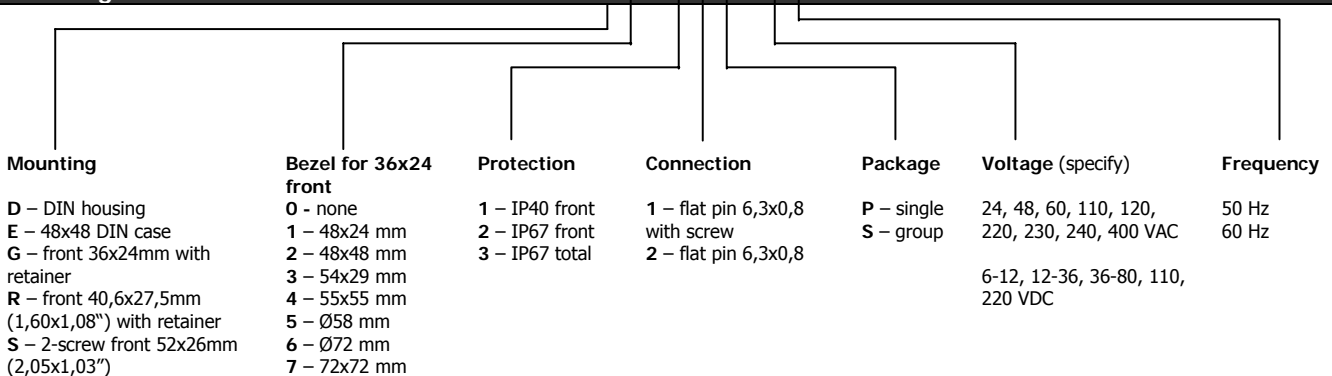

# Hour meter

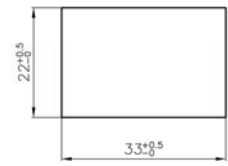
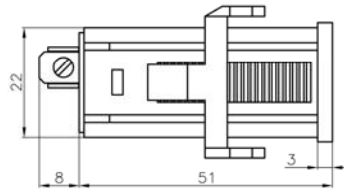
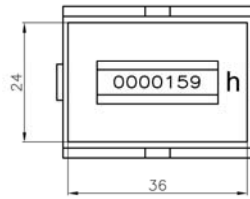

HK 30 – mounting G

Panel cut-out

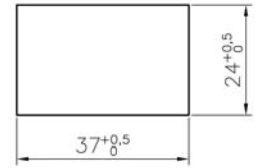
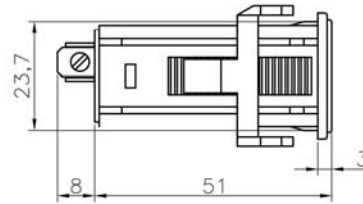
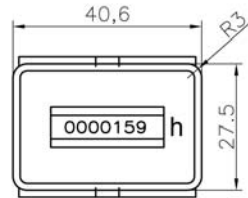

HK 30 – mounting R

Panel cut-out

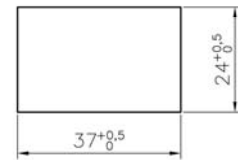
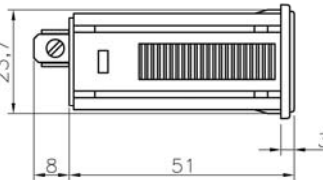
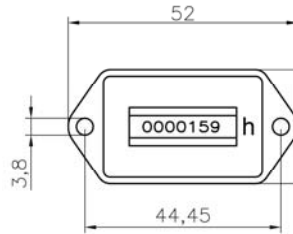

HK 30 – mounting S

Panel cut-out

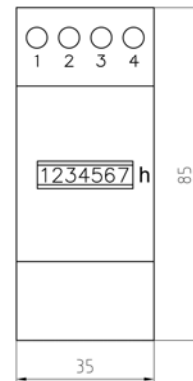
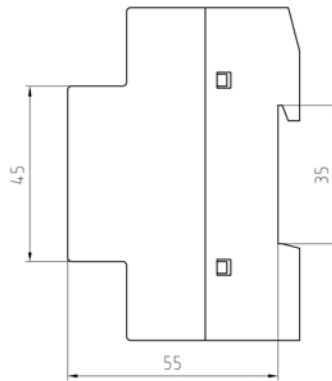
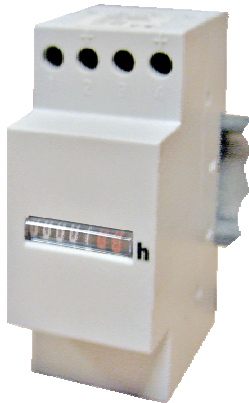

HK 30 – mounting D

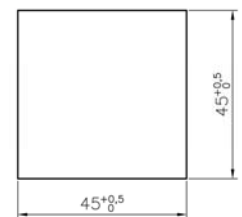
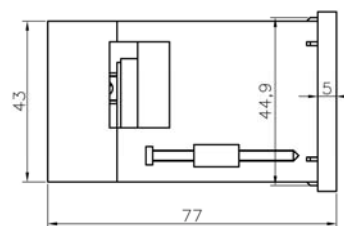
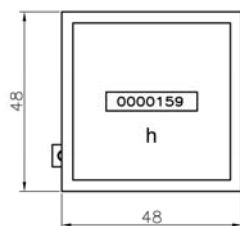

HK 30 – mounting E

Panel cut-out

# Hour meter

HK 30 bezels – for 36x24 mm front meter

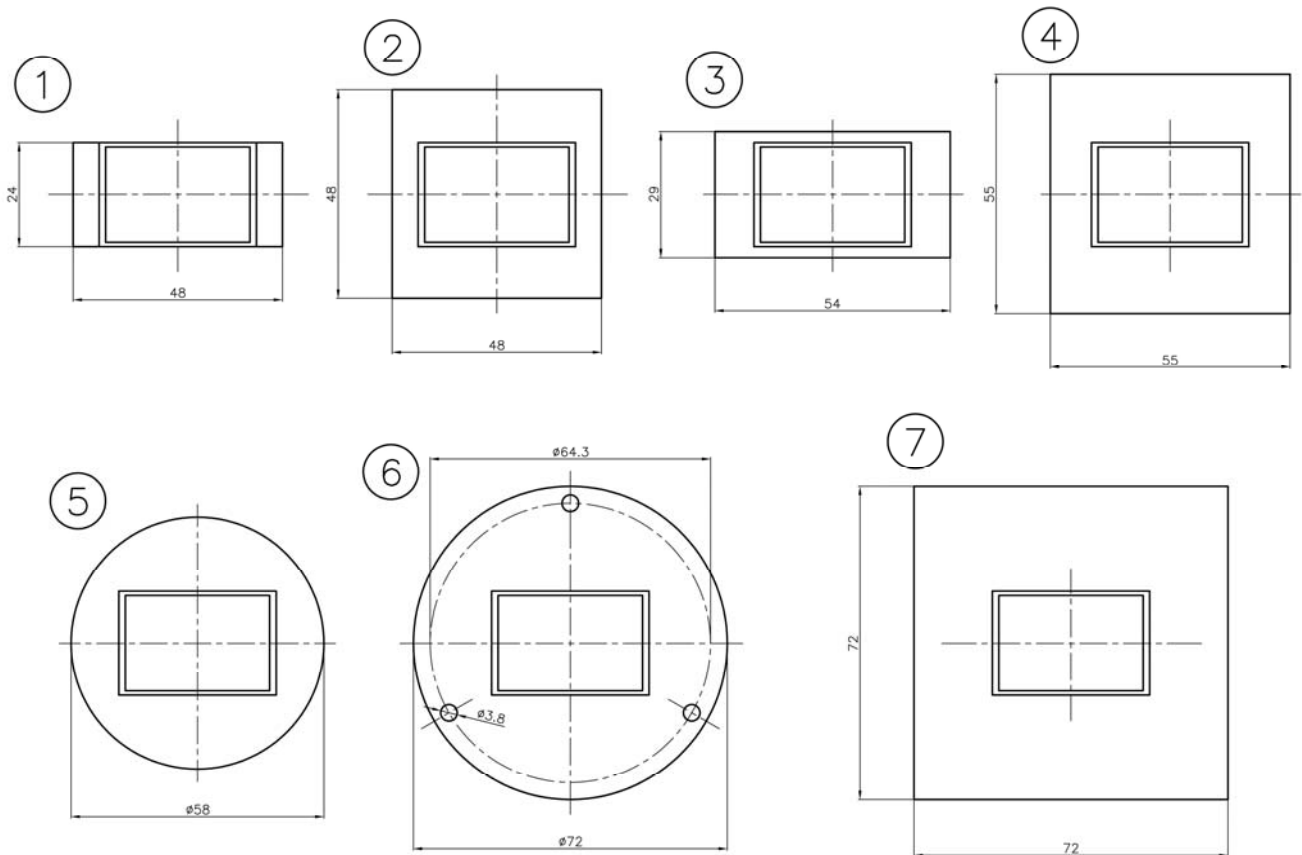

Bezel No.	Bezel size	Panel cut-out	Retainer size
1	48 x 24 mm	45 x 22 mm	standard
2	48 x 48 mm	45 x 45 mm	bigger
3	54 x 29 mm	50 x 25 mm	standard
4	55 x 55 mm	45 x 45 or 50 mm	bigger
5	58 mm	50 mm	bigger
6	72 mm	min. 50 mm	standard
7	72 x 72 mm	45 x 45 or 50 mm	bigger